

# ALERT TUBING FABRICATORS

AS9100D / ISO9001:2015 CERTIFIED AND NADCAP CERTIFIED FOR WELDING

Small Business Veteran-Owned



# BENDING CAPABILITIES 1/8" UP TO 5" OD



## **SB-127X6B-1S/2S**

OD 127mm , Heavy Duty Tube  
Bender ( 6 axis )



## **SB-32X7A-2S-V-U**

Our SB-32 CNC machines can not only bend with a high degree of precision for any size run, they can create highly precise prototype parts.



**SB-52X10A-2S-V-U**



**SB-63X9A-MRV**

Alert has 4 **CNC** bending machines that have been **REBUILT** and **DIGITIZED** to enhance precision. We have Pines 3/4, 1, 1 1/4, and 2 machines.

# CNC ROLL BENDING AND COILING

PBT-35 ROLL BEND UP TO 8" TUBES



PBT-25 ROLL BEND UP TO 4" TUBES



Custom Coiling and Roll Bending Tubes

# FULL MACHINE SHOP



**MORI DMF 200/8**

**Max. X-axis travel** 2000 mm  
**Max. Y-axis travel** 800 mm  
**Max. Z-axis travel** 850 mm



**DMG MORI | DMU 75**

**Max. X-axis stroke** 750 mm  
**Max. Y-axis stroke** 650 mm  
**Max. Z-axis stroke** 560 mm

# MORE MACHINING CAPABILITIES



**DMG MORI | NLX 2500 | 700**

**10-inch Chuck Size Turning  
Center with Varieties of  
Specifications**



**DMG MORI | NLX 2500-1250**

**10-inch Chuck Size Turning  
Center with Turning Length of  
up to 1,255 mm**

# MACHINE SHOP CONTD.



**DMG MORI | SPRINT 32|8**  
Swiss lathe for turning small  
nuts, bolts, and screws.  
Max. workpiece diameter 1.3 in.  
Max. workpiece length 9.4 in.  
Max. bar diameter 1.3 in.  
Max. X-axis travel 2.8 in.  
Max. Y-axis travel 15.9 in.  
Max. Z-axis travel 3.9 in

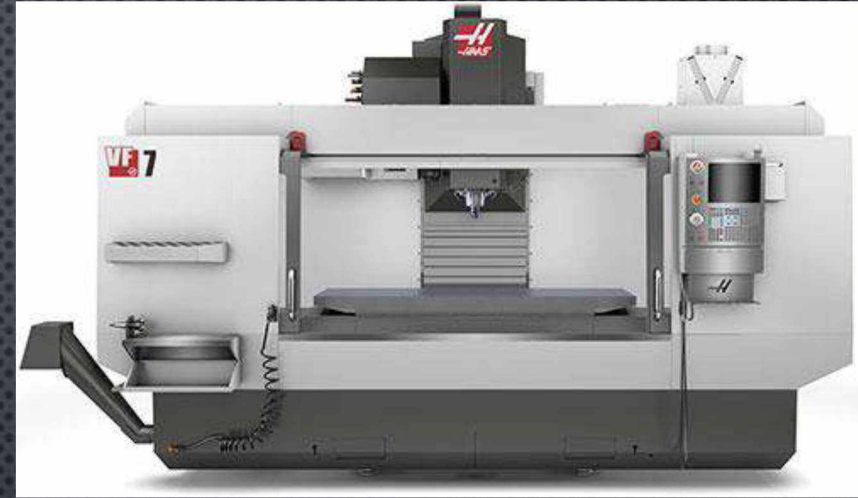

**VF7 / TR 210 / TRT210 Trunnion**

**Travels - S.A.E - Metric**  
X Axis - 84.0 in - 2134 mm  
Y Axis - 32.0 in - 813 mm  
Z Axis - 30.0 in - 762 mm

Spindle Nose to Table (~ max) 34.0 in -  
864 mm  
Spindle Nose to Table (~ min) 4.0 in -  
102 mm

# EDM WIRE MACHINE / EDM HOLE POPPER



Alert Tubing now uses the SEIBU MD50 EDM wire machine, extremely precise and fast.



**YGS-43EZ STANDARD  
EDM Hole Popper**

# ORBITAL WELDING AND BRAZING



**Orbitalum Smart Welder  
OM180**

We can orbital weld  
stainless steel, mild steel,  
Inconel and Titanium from  
1/8" to 10".



**Miller and IPG's Newest  
Laser welder OPT X 2KW**



**Dynasty 400 DX, Dynasty 300 DX,  
Millermatic 250, and Resistance  
Projection Spot Welding**



**Induction Brazing Per AWS C3.5  
And Torch Brazing Per AWS C3.4**

# KEYENCE 3D MEASUREMENT SYSTEMS



XM-5000 CMM FOR THE LARGER PARTS



KEYENCE VL700 LASER FOR MACHINED PARTS AND SMALL TUBE ASSEMBLIES

# LASER ETCHING AND DOT PEEN PRINTING



**FM-STATION Boss Fiber  
Laser Marking Machine**



**Flymarker mini 120/45 plus  
Hand Held Dot Peen Printer**



**Kwik Mark KM-64**

Alert Tubing does high quality part marking and production marking for our customers.



# VTUBE LASER

World-class Metrology for Tube Fab

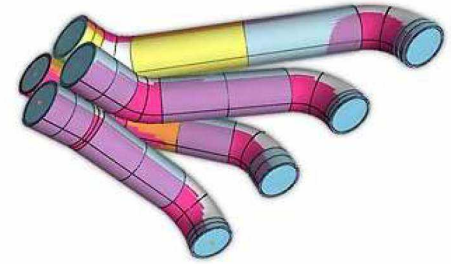

Qualify tube shapes and automatically correct benders.

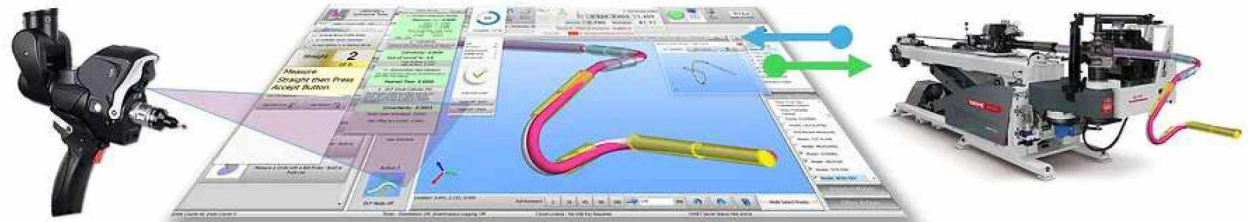

# VTUBE LASER

World-class Metrology for Tube Fab

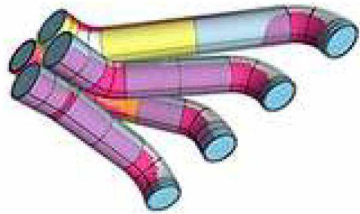

BREAKING THE CAD BARRIER

# VTUBE STEP

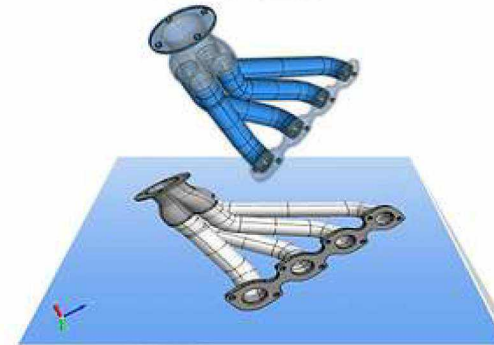

# FLARING AND PARFLANGE CUSTOM 37 DEGREE AND 45 DEGREE FLARED JOINT SERVICES



Custom 90 Degree Seal-Lok Services

# BEADING AND SWAGE



**TSM-3.5-SWAGING-  
MACHINE - 3/8" to 3.5"**

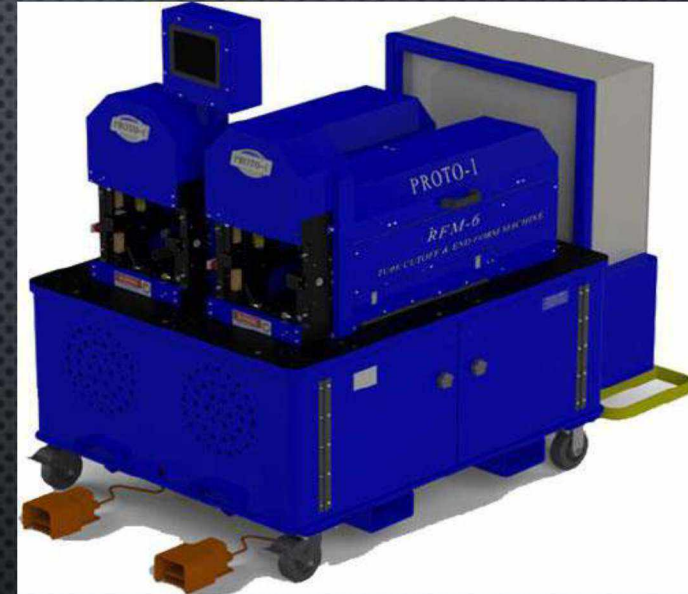

**RFM-6 BEADING MACHINE -  
BEADING FROM 5/8THS TO 6  
IN TUBES**

# REDUCING AND EXPANDING



**Model M71-H-3 Tube End Forming System**



**Custom Huth  
Expander and Swager**

# LASER, COLD SAW, AND CHOP SAW



**Custom Hyd-Mech  
Horizontal Miter Saw Services**

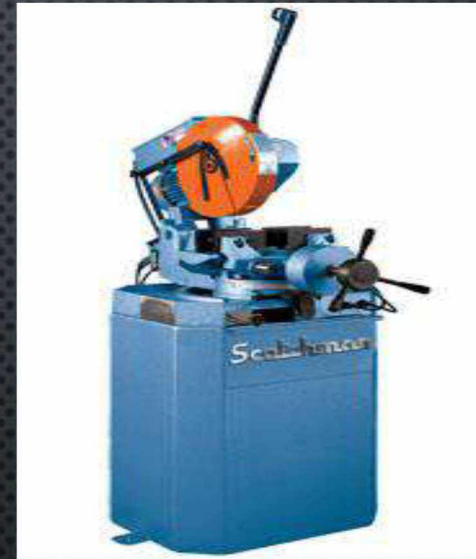

**Custom  
Scotchman/Everett Cold  
Saw Services**

# LASER, COLD SAW, AND CHOP SAW



Do ALL S400 Horizontal Saw

## HABERLE H350H

WE HAVE THE ABILITY TO MITER CUT JUST ABOUT ANY SHAPE, MATERIAL, OR SIZE OF TUBING.



## **Flatten, Trim, Pierce, Slotting, dimple punching and Notching**

### **Custom Flatten, Trim, And Pierce Services**

A punch press operation that is a cost-effective way to produce a flat tube end for tubular assemblies.

### **Custom Slotting Services**

A punch press operation that introduces an open-ended slot into the end of the tube.

### **Custom Notching Services**

Combines a punch press with a dedicated punch die to reshape the end of a tube.

### **CNC Dimple Hole Punching**

One of the options that we purchased with the SOCO SB-32 left/right-hand bender was the CNC dimple hole punching capability.

### **Custom Mandrel-Style Hole Punching Services**

Our cost-effective means of punching round, square, and rectangular holes in metal tubing.

## High Pressure & All-Metal Hose Assemblies

### **Stainless Steel Braided PTFE Lined Hose Assemblies**

PTFE-lined stainless steel hoses made to order. These PTFE Hose assemblies can handle up to 5,000 PSI. The benefit of these hoses are that the PTFE liner will not impart taste or odor and has a non-stick surface, which makes it ideal for running chemicals, adhesives, and Solvents.

### **Stainless Steel Braided All-Metal Hose Assemblies**

All metal lined stainless steel braided hose assemblies made to order. These all metal hoses can handle temperatures up to 1500 F. These hoses can be made with many different configurations such as fitting styles, fitting material, liner material, and more. Contact us today with your requirements.

## FACILITY

- OFFICE SPACE – 2000 FT<sup>2</sup>
- SHOP FLOOR – 18000 FT<sup>2</sup>
- OPERATING CAPACITY
- 1 ST SHIFT – 40% TO 50%
- 2 ND SHIFT – 100%
- 3 RD SHIFT – 100%



# CONTACT US TODAY!

MAIN TELEPHONE: +1 815-633-5065

ALERT TUBING FABRICATORS, INC.

8019 COMMERCIAL AVE

LOVES PARK, IL 61111

kevin@alerttubing.com President (ext 104)  
jim@alerttubing.com Estimating Manager (EXT 109)  
ehren@alerttubing.com Operations Manager (ext 103)  
dustin@alerttubing.com CNC Engineering Manager (ext 108)  
sharon@alerttubing.com Accounting Manager AP / AR / (ext 105)  
mitchell@alerttubing.com Order Processing Manager (ext 102)  
vicki@alerttubing.com Purchasing Manager (ext 101)  
jeff@alerttubing.com Quality Manager (ext 107)  
ron@alerttubing.com Quality Engineer (ext 106)  
james@alerttubing.com VP of Sales and Marketing

[www.alerttubing.com](http://www.alerttubing.com)

